

DOUBLE PENDANT CANOPY

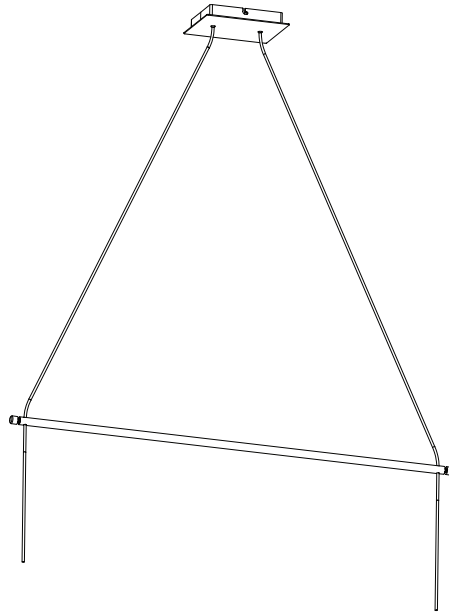

CAUTION:

-Professional installation is strongly recommended.
 -READ these safety instructions entirely prior to installation.
 -DO NOT BEGIN INSTALLATION UNTIL ALL ELECTRICAL POWER TO THE INSTALLATION SITE HAS BEEN TURNED OFF AT THE CIRCUIT BREAKER!

THIS PRODUCT INCLUDES:

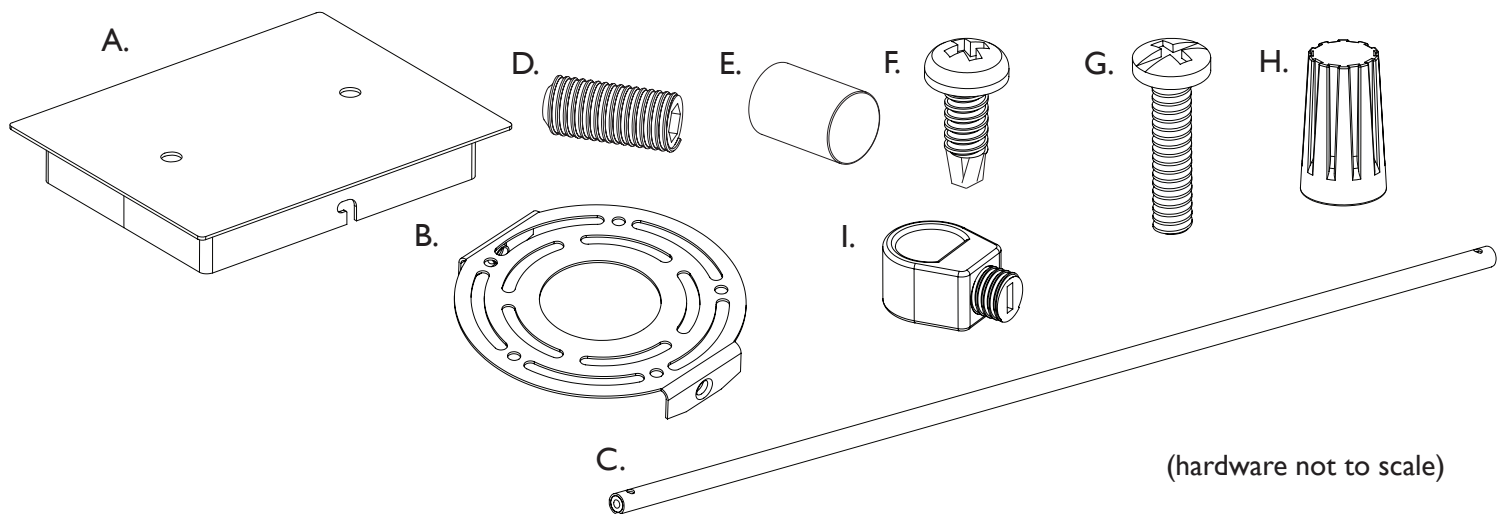

(hardware not to scale)

- A. - Canopy plate
- B. - Mounting plate
- C. - Spacer bar
- D. - Spacer bar thumb screw (x2)

- E. - Spacer bar end cap (x2)
- F. - Assembly screws (x2)
- G. - Mounting screws (x2)
- H. - Wire nuts (x2)
- I. - Strain relief (x2)

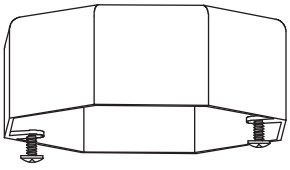

Attention: If you do not have an existing electrical junction box in your intended installation site, have one installed by a licensed electrician.

RECOMMENDED TOOLS AND MATERIALS:

Tall step ladder
Tape measure
Wire stripper

Utility knife
Phillips screwdriver
Small blade screwdriver

Electrical tape
Level

1

Determine the desired cord length for each pendant you plan to use with the double pendant canopy. Use a tape measure to measure the length from your ceiling or hold the pendant cord to the ceiling and adjust to desired pendant height. Use tape to mark the pendant cord 6" above your desired length (the spreader bar will shorten the final height of your pendant by 6"). Cut each of the pendant cords an additional 6" above your tape mark. Discard any excess wire.

2

Starting at the cut end, carefully strip back each of the pendant cords' outside insulation to about halfway from the tape marks. Next, strip back approximately 3/4" of the insulation on each of the inner wires.

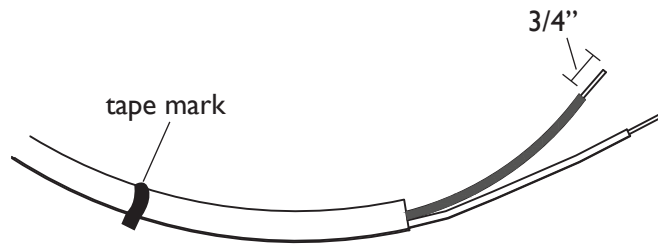

3

Unscrew the spacer bar end caps and set screws before inserting the pendant cords up through the holes on either end of the spacer bar. Do not re-assemble the set screws or end caps yet. Next, insert the pendant cords up through the holes on the canopy plate.

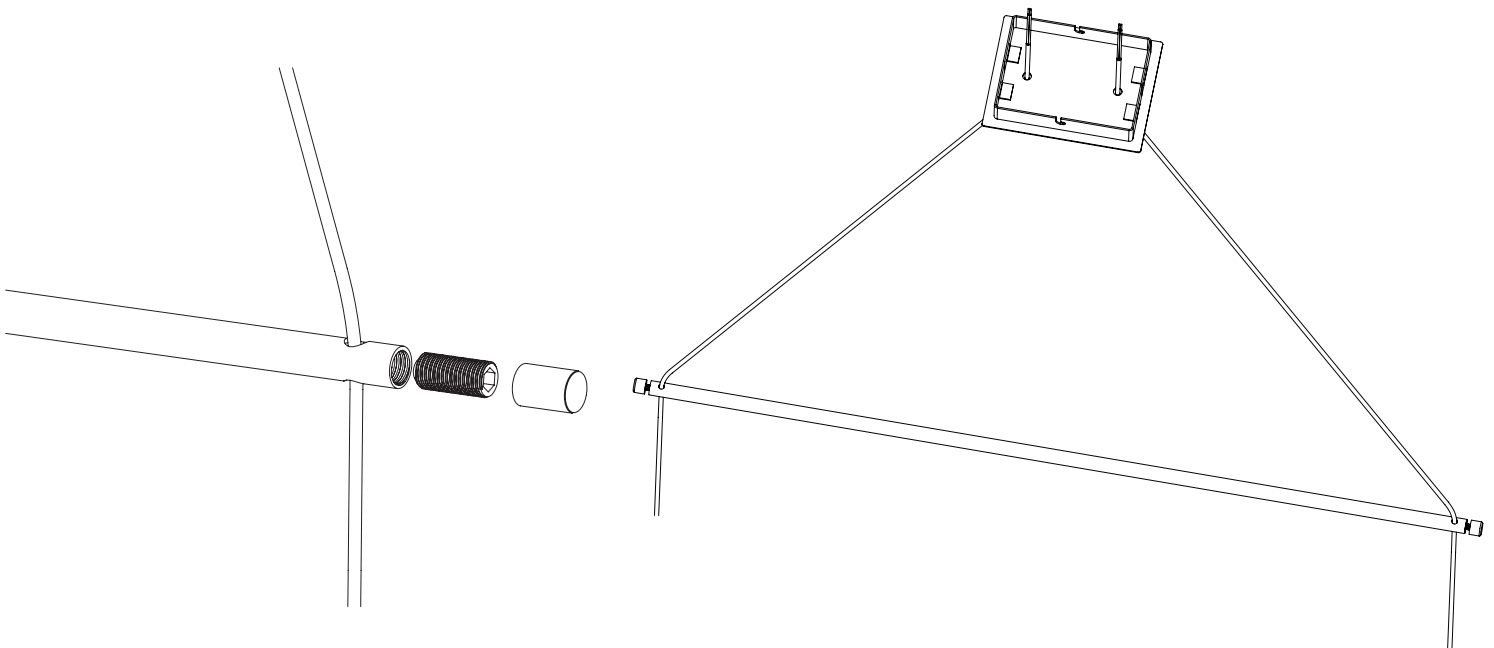

4

Slide a strain relief down onto each of the pendant cords and use a small flat blade screwdriver to tighten them 1.5" below your tape mark.

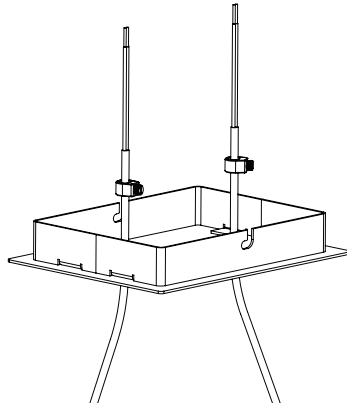

5

Use the included mounting screws to secure the mounting plate to the electrical junction box through any hole that corresponds with your junction box's mounting holes. The orientation of the mounting plate determines the final orientation of your canopy. Orient the mounting plate such that the two tabs hang down and correspond with the intended front/back of your pendant pairing. Partially screw in the included assembly screws to the outside of the tabs on the mounting plate. Align the mounting screws with the slots on the sides of the mounting plate.

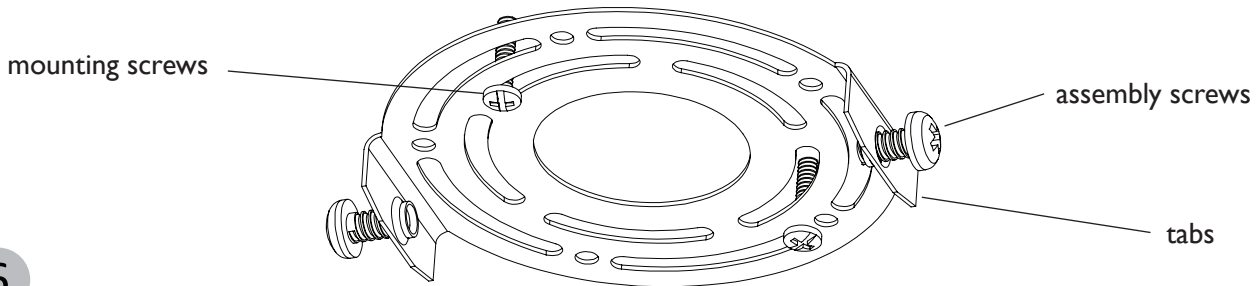

6

Twist together the black (hot) wires from each pendant to the black (hot) wire from the junction box using one of the provided wire nuts. Then, twist together the white (neutral) wires from each pendant to the white (neutral) wire from the junction box using one of the provided wire nuts.

Note: For heavier pendants, consider tying a knot in the pendant cord above the strain relief before twisting the wires together for added security.

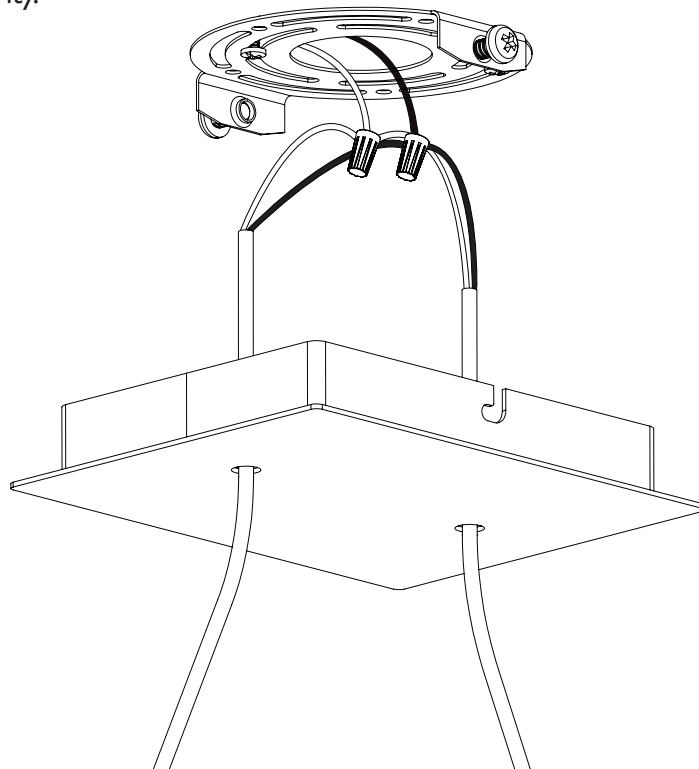

7

Carefully tuck all wires inside the canopy plate before lifting it up and over the mounting plate. Move the mounting plate laterally to guide the mounting screws along the channel before fully tightening the screws.

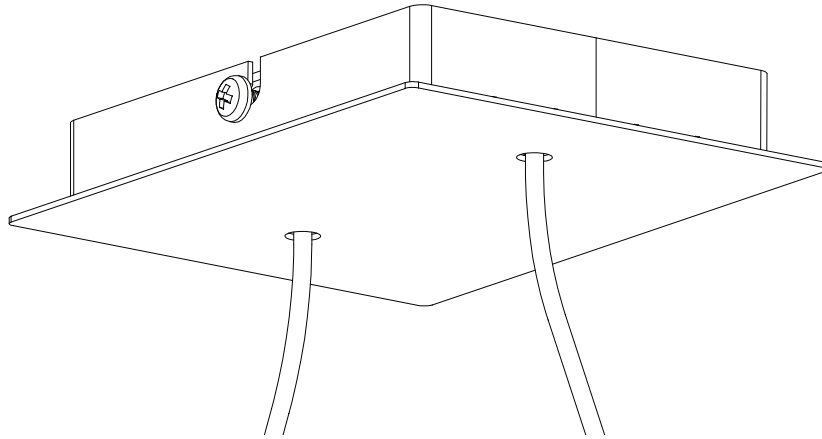

8

Determine the desired position of the spacer bar. The spacer bar can be moved up and down the pendant cords anywhere between the canopy plate and the pendants. Re-insert the set screws on either end of the spacer bar and hand tighten. Then, tighten the end caps over the set screws to lock the bar in place.

SPECIAL CONSIDERATIONS:

When choosing the proper length of each pendant cord, we recommend a minimum of 22" between tables or eating surfaces and the bottom of the pendants.