

DUO SMALL AND LARGE TABLE LAMP (NOT FOR DUO MICRO)

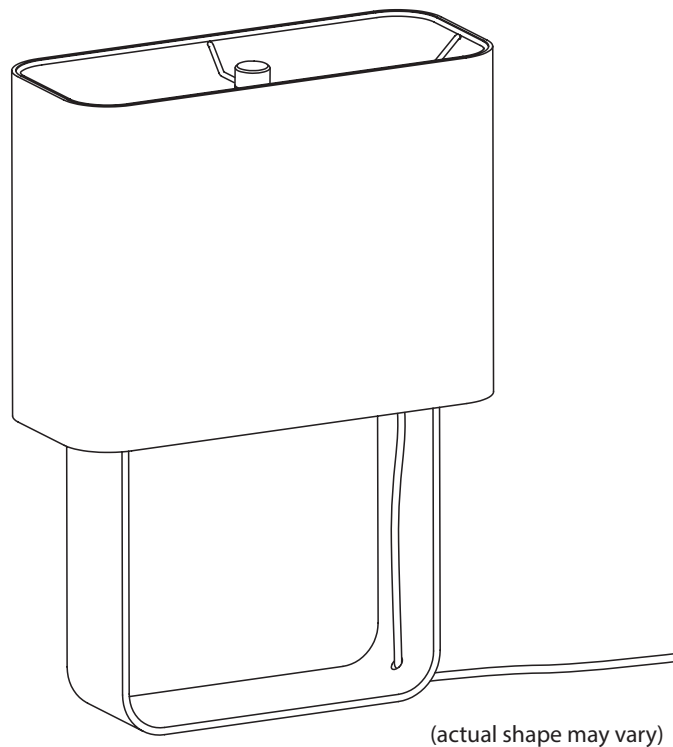

Recommended Tools

- Phillips Head Screwdriver

This Product Includes

- A. Duo Lamp Base
- B. Duo Lamp Shade
- C. Assembly Screws (x2)
- D. Finial
- E. Bulb(s)

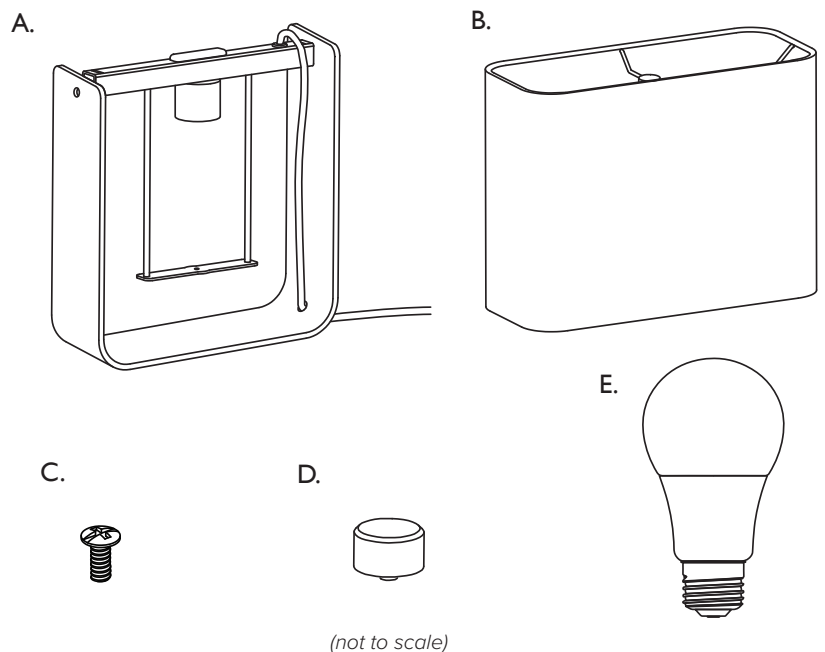

Assembly Instructions

- 1** The Duo Lamps ship with the harp and bulb socket inverted, for protection.
- 2** Use a Phillips head screwdriver to remove screws.
- 3** Gently pull top corners of Duo lamp base and remove the harp/socket component.
- 4** Flip component, so socket and harp facing upwards place the horizontal tube back onto square mounts.
Note: Make sure power cord is not wrapped around horizontal tube after flipping component. See figure 3 for proper cord placement.
- 5** Return screws to location and tighten with Phillips head screwdriver
- 6** Place shade on top, and tighten down with finial.

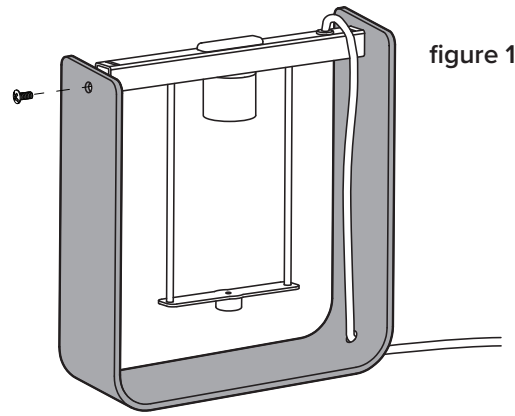

figure 1

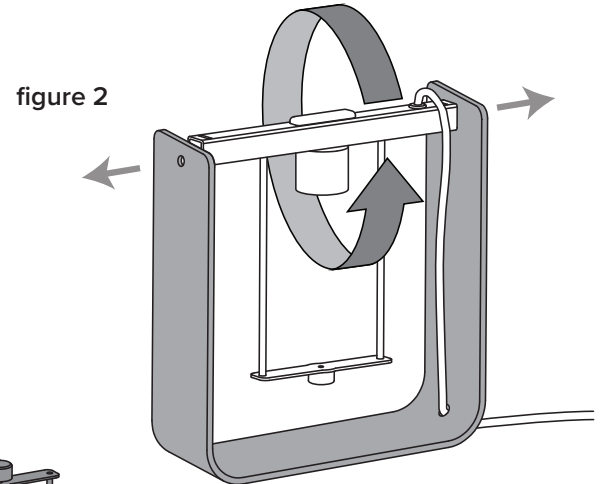

figure 2

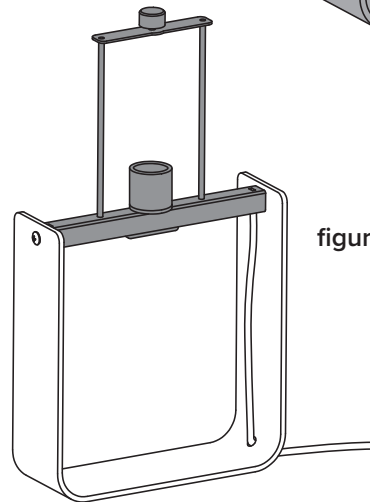

figure 3

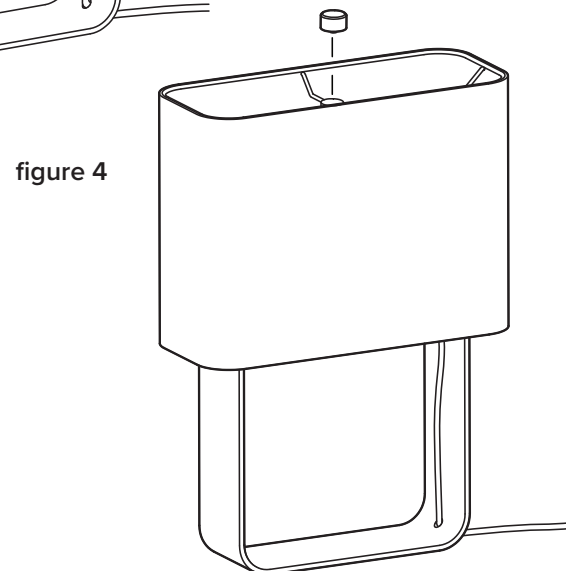

figure 4