

HENSON TABLE LAMP

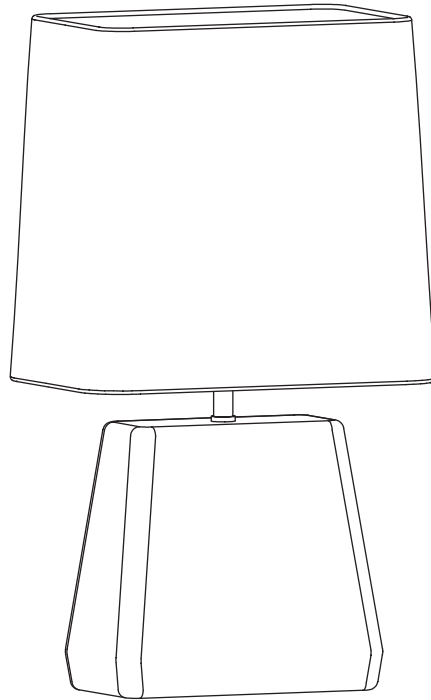

THIS PRODUCT INCLUDES:

A.

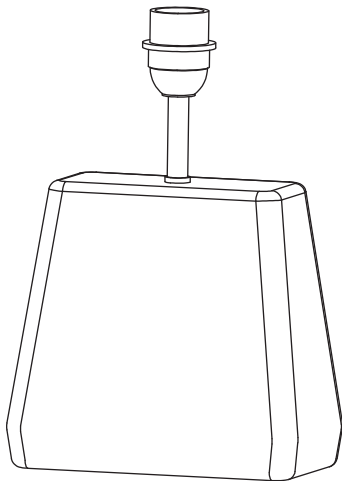

B.

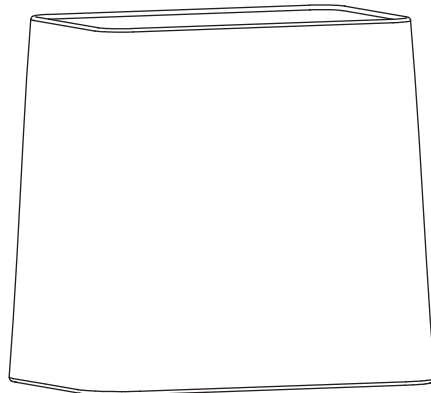

C.

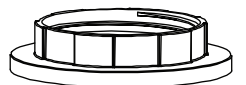

D.

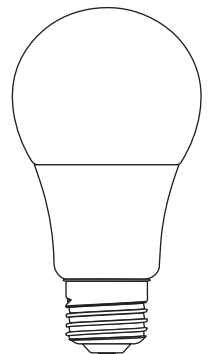

- A. - Henson lamp base
- B. - Henson lamp shade
- C. - Plastic shade ring (ships screwed to base)
- D. - Dimmable LED light bulb

1

Unscrew the plastic shade ring from the socket by turning it counterclockwise.

2

With the metal crossbars facing down, place the shade over the threaded socket. Use the plastic shade ring to fasten the components together before screwing in the light bulb.

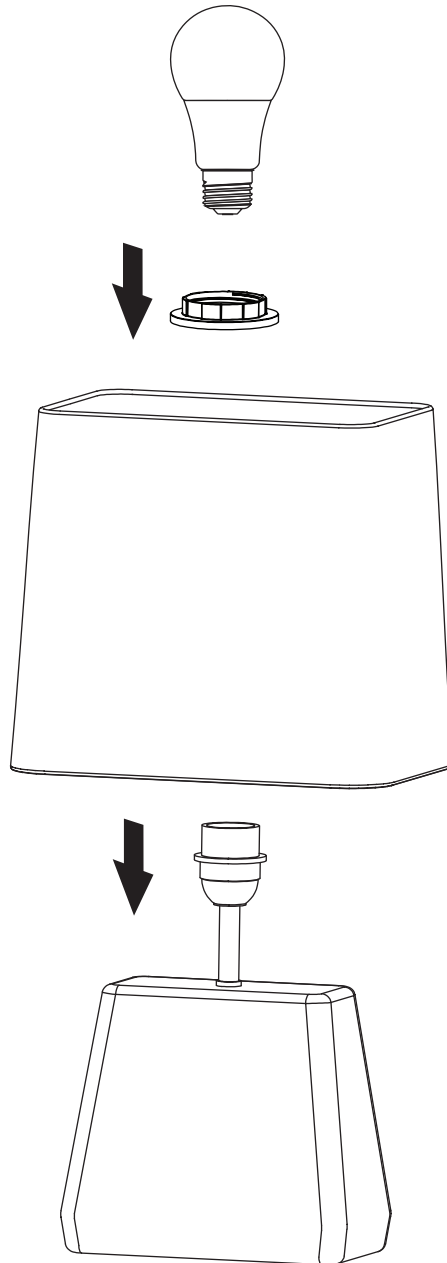

SPECIAL CONSIDERATIONS:

Not all light bulbs are dimmable. Order replacement bulbs at roomandboard.com.