

## A GUIDE TO L-SHAPED DESKS



Portica L-shape desk with cherry wood top.

L-Shape desks are available in the following collections: Parsons, Portica, Pratt, and can also be configured using Parsons, Portica, Penn and Stanton desk legs.



Parsons



Portica



Pratt



Parsons legs



Penn legs



Portica legs



Stanton legs

### THREE WAYS TO SHOP

#### ROOMANDBOARD.COM

Shop our complete collection 24 hours a day. You'll find design advice and all the sizes and colors we offer.

#### VISIT OUR STORES

Shop with a Design Associate who will help you choose the perfect pieces for your lifestyle.

#### 800.301.9720

Call Shop Room & Board from Home. Our Design Associates answer questions and give suggestions to help you shop.

800.301.9720 | [roomandboard.com](http://roomandboard.com)

1/1/13

**Room&Board**<sup>®</sup>  
CLASSIC CONTEMPORARY  
HOME FURNISHINGS

## DESK AND RETURN SIZES

36 x 18



60 x 24



72 x 24



48 x 24



60 x 30



72 x 30



84 x 24



48 x 30



60 x 36



72 x 36



78 x 42

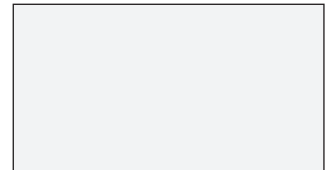

## SAMPLE CONFIGURATIONS

1

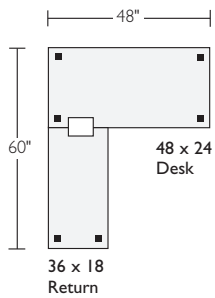

2

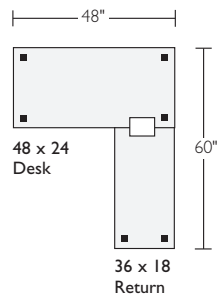

3

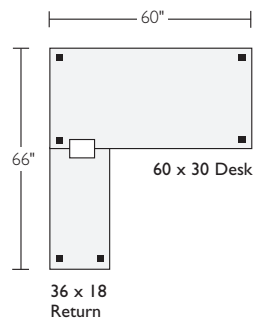

4

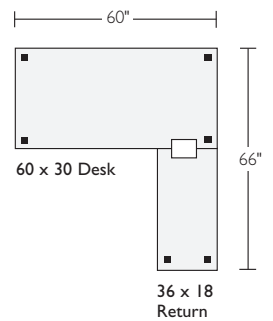

5

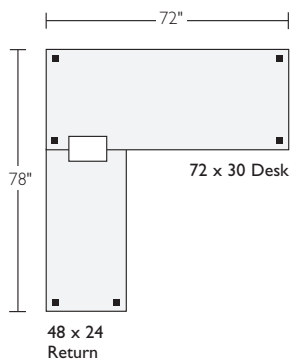

6

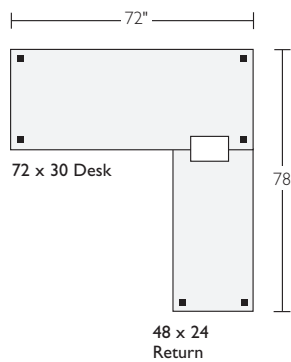

### Key

- Leg position
- 8" x 6" Plate for 18" return
- 12" x 8" Plate for 24" return
- 18" x 8" Plate for 30" return

# CREATE YOUR OWN CONFIGURATION

---

Use the grid below to create your own desk configuration. Tips: Most L-shaped desks require six legs; U-shaped desks require eight legs. Please work with a Design Associate to ensure that you order the correct configuration.

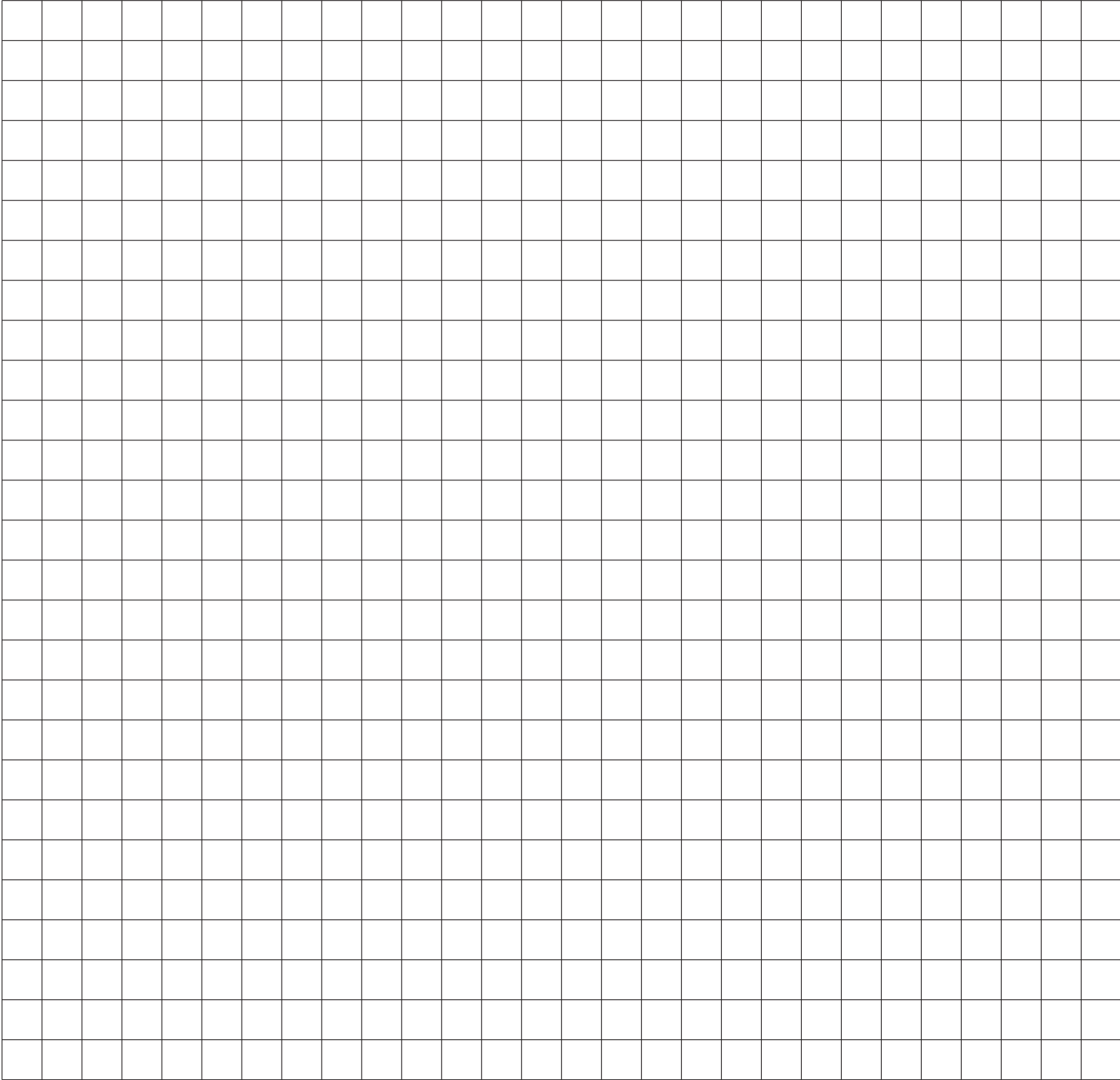

**Notes**

---

---

\_\_\_\_\_  
Sales order #

\_\_\_\_\_  
Design Associate

\_\_\_\_\_  
Customer name

\_\_\_\_\_  
Delivery date