

Mounting to DRYWALL with no stud found (For stud mounting, use other side)

Tools



Phillips Screw Driver



Pencil

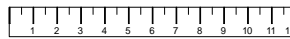

Ruler or Tape Measure



Level

1

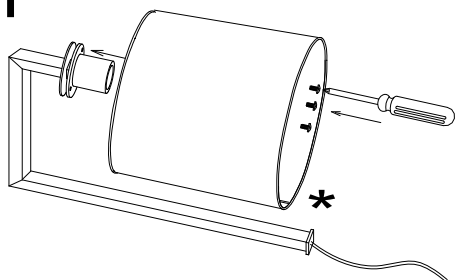

Remove the three small screws from the lamp socket and use them to attach the shade.

* Put the shade seam to the rear.

2

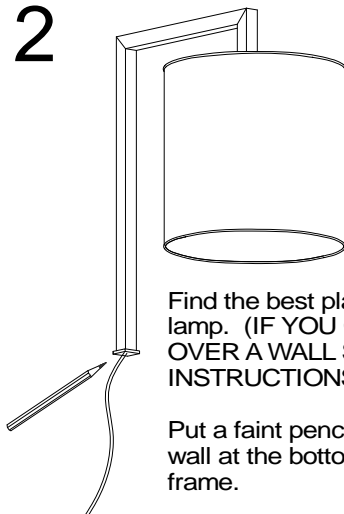

Find the best place to mount the lamp. (IF YOU CAN PLACE IT OVER A WALL STUD, USE THE INSTRUCTIONS ON OTHER SIDE)

Put a faint pencil line on the wall at the bottom of the lamp frame.

3

10.5"

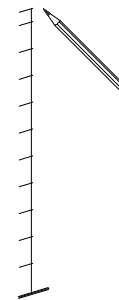

Measure up 10-1/2" from the pencil line and put a cross mark on the wall.

4



Drive in one of the plastic drywall anchors. Push hard with the screwdriver and it will turn in. Make sure the anchor is flush to the wall.

5

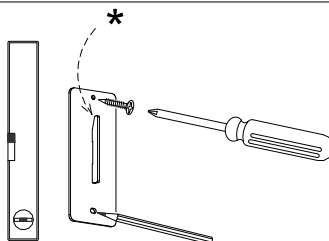

Make sure the mounting hook* is up.

Use the first SHORT screw to fasten the mounting plate through the top mounting hole.

Use a level to make sure the plate is vertical and mark the wall through the lower hole.

6

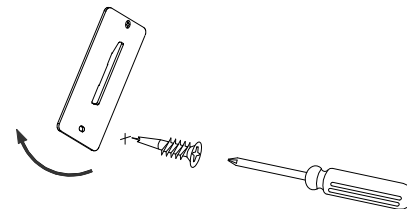

Tilt the plate out of the way and install the second drywall anchor.

7

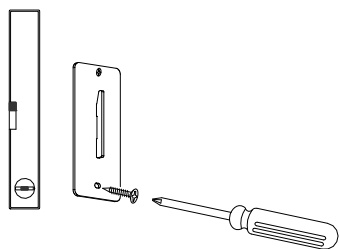

Drive in the second SHORT screw.

Do another level test to make sure the mounting plate is vertical.

Tighten both screws.

8

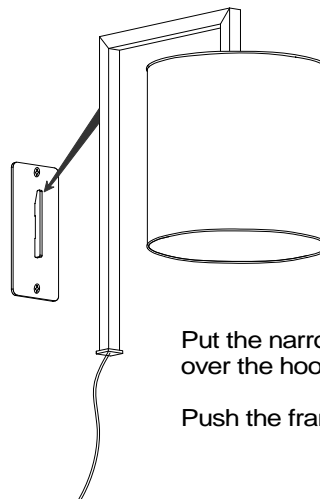

Put the narrow slot in the back of the frame over the hook on the mounting plate.

Push the frame down to lock it in place.

Mounting over WALL STUDS

(For drywall only, use other side)

Tools

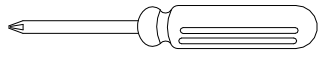

Phillips Screw Driver



Pencil

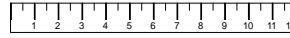

Ruler or Tape Measure



Level

1

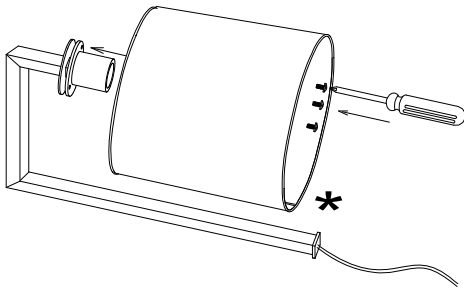

Remove the three small screws from the lamp socket and use them to attach the shade.

* Put the shade seam to the rear.

2

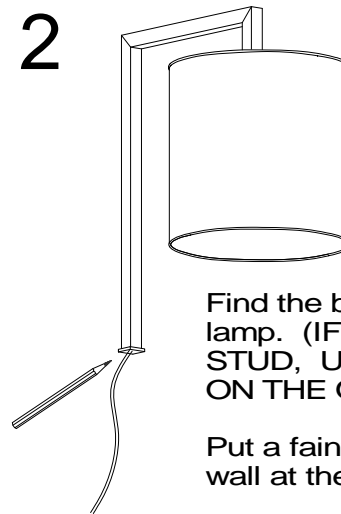

Find the best place to mount the lamp. (IF IT IS NOT OVER A WALL STUD, USE THE INSTRUCTIONS ON THE OTHER SIDE)

Put a faint pencil line on the wall at the bottom of the lamp frame.

3



Measure up 10-1/2" from the pencil line and put a cross mark on the wall.

4

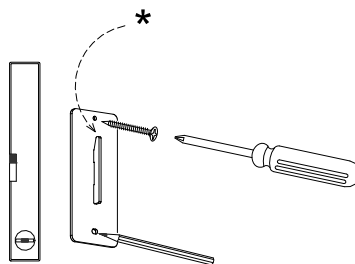

Make sure the mounting hook* is up.

At the cross mark use the first LONG screw to fasten the mounting plate through the top mounting hole.

Use a level to make sure the plate is vertical.

5

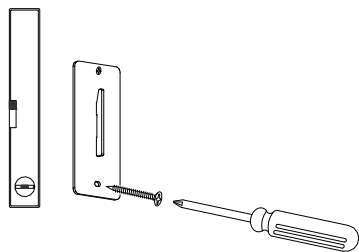

Put in the second LONG screw.

Do another level check to make sure the mounting plate is vertical.

Tighten both screws.

6

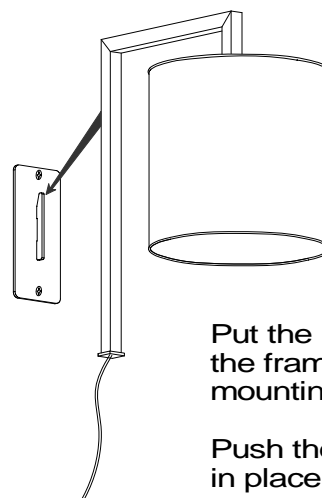

Put the narrow slot in the back of the frame over the hook on the mounting plate.

Push the frame down to lock it in place.