

Pablo®

AVI

ASSEMBLY & INSTALLATION INSTRUCTIONS

INFO@PABLODESIGNS.COM
888 MARIN STREET
SAN FRANCISCO, CA
94124

Pablo[®]

AVI

SHADE INSTALLATION

MAGNETIZE SHADE TO TABLE POST

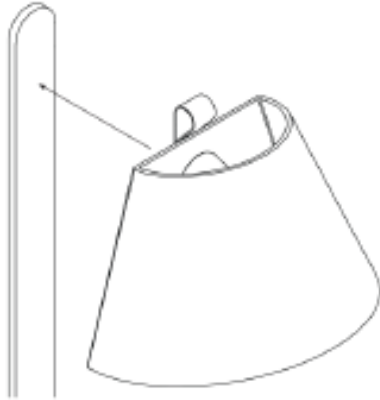

CABLE MANAGEMENT

USE PROVIDED CORD CLIP

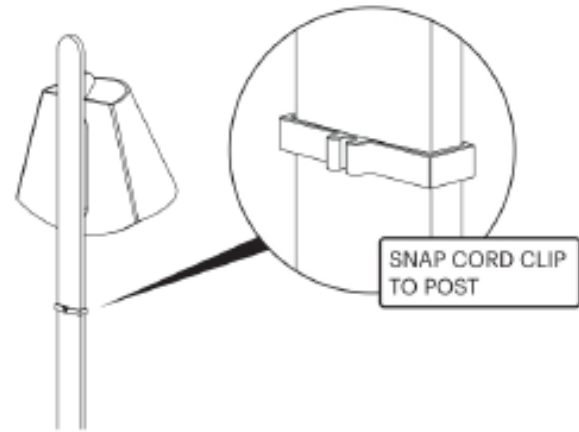

ADJUSTMENT

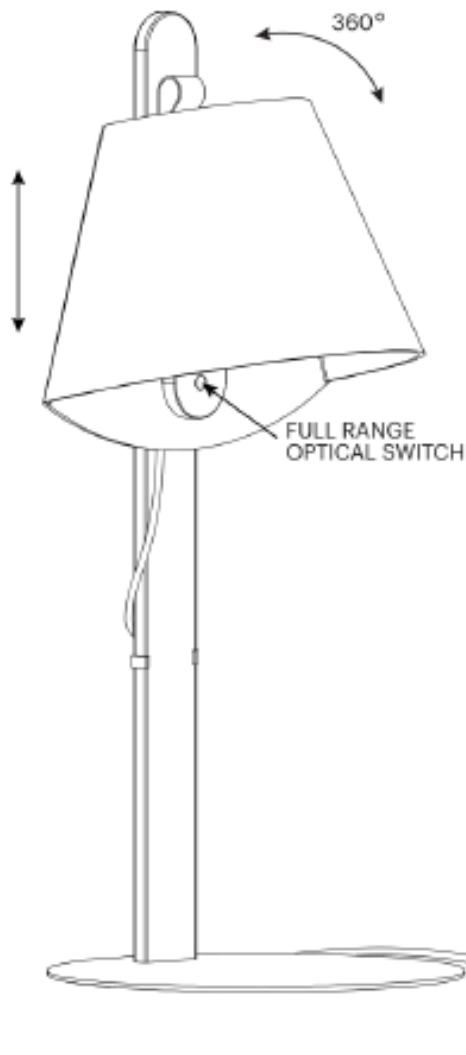

SWITCH FUNCTION

TAP OPTICAL SWITCH BRIEFLY TO CYCLE THROUGH HIGH, LOW AND OFF. PRESS AND HOLD OPTICAL SWITCH TO ACTIVATE FULL RANGE DIM CONTROL. RELEASE FINGER FROM OPTICAL SWITCH WHEN DESIRED LIGHT LEVEL IS REACHED

CARE INSTRUCTIONS

WIPE LED MODULE AND MOUNTING BASE WITH A SOFT DAMP CLOTH. AVOID AMMONIA-BASED CLEANERS. DUST FELT SHADE WITH STANDARD LINT ROLLER.

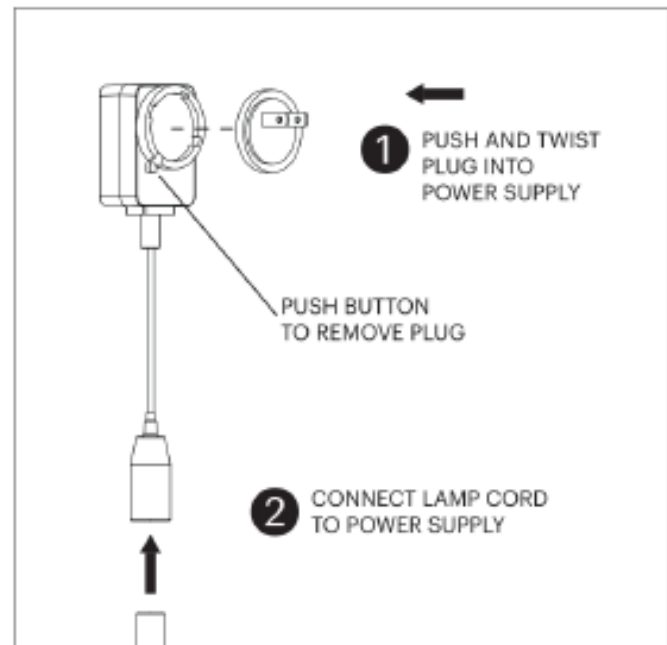

NOTE: CONTACT MANUFACTURER FOR ADDITIONAL PLUG TYPE REQUIREMENTS.