

HADDIE TABLE LAMP

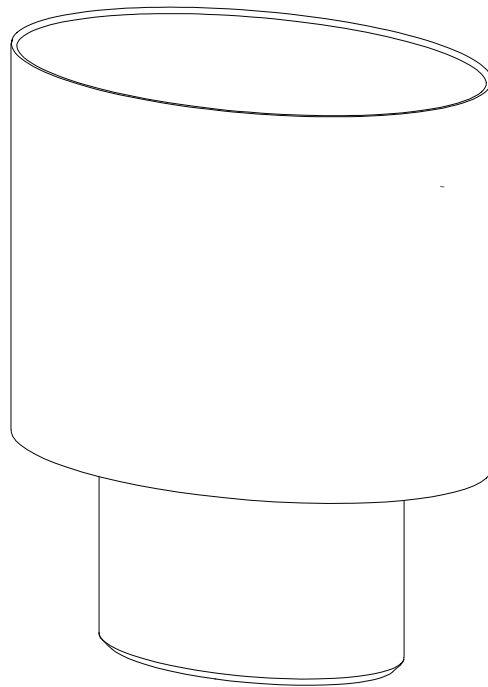

THIS PRODUCT INCLUDES:

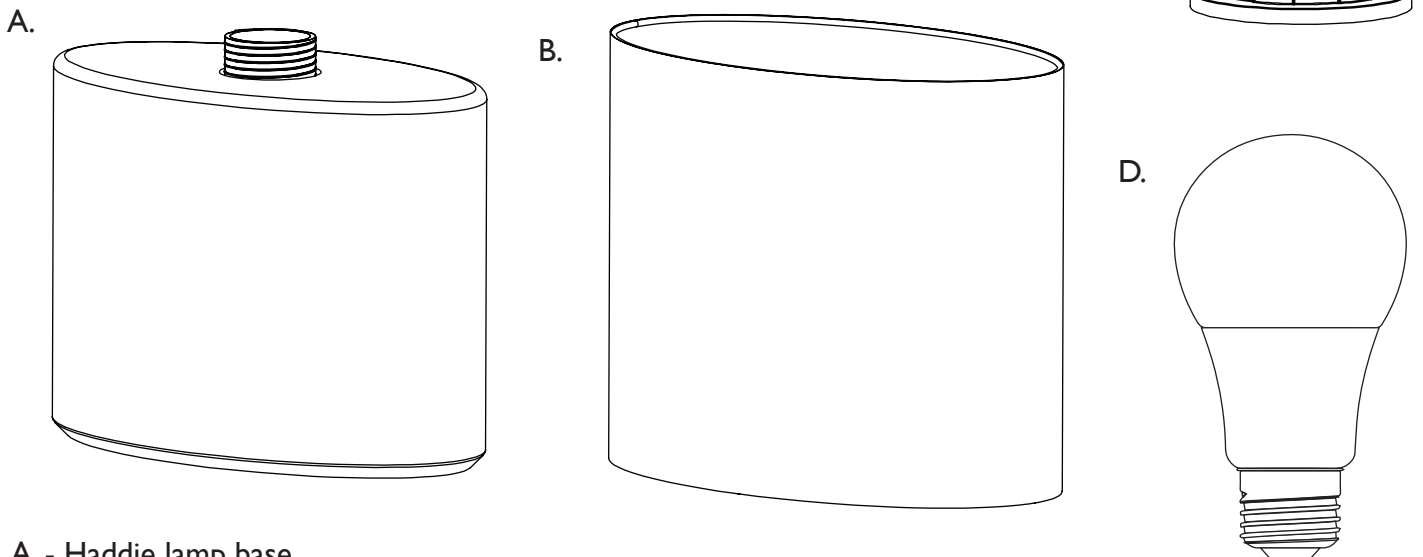

- A. - Haddie lamp base
- B. - Haddie lamp shade
- C. - Plastic shade ring (ships screwed to base)
- D. - Dimmable LED light bulb

1

Unscrew the plastic shade ring from the wooden base by spinning it counterclockwise.

2

Place the shade with the metal crossbars facing down over the threaded socket on the wooden base. Use the plastic shade ring to fasten the components together before screwing in the light bulb.

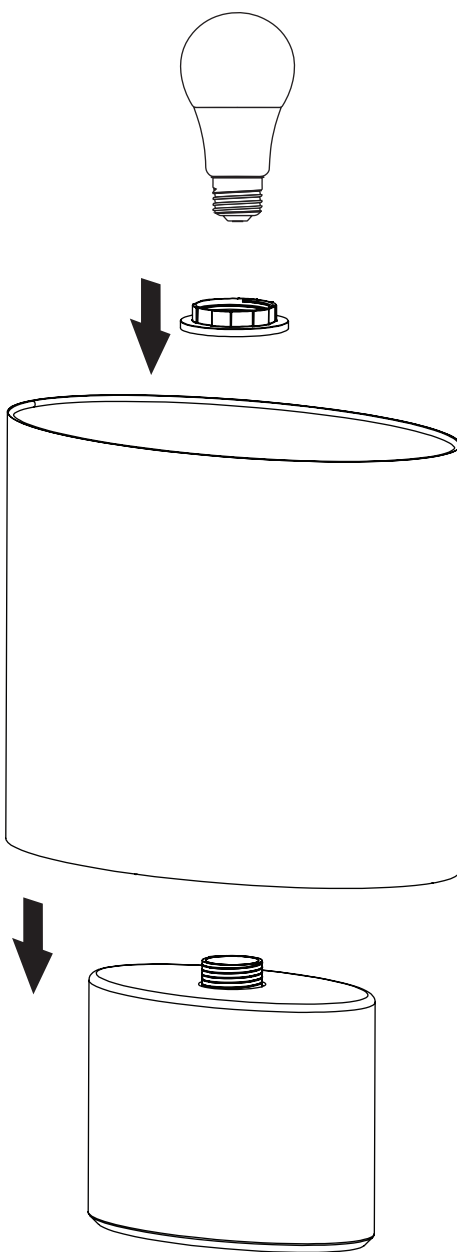

SPECIAL CONSIDERATIONS:

Not all light bulbs are dimmable. Order replacement bulbs at roomandboard.com.