

ISABELLE

ISABELLE

ASSEMBLY & INSTALLATION INSTRUCTIONS

INFO@PABLODESIGNS.COM
888 MARIN STREET
SAN FRANCISCO, CA
94124

PABLODESIGNS.COM



APPROVED COMPONENTS

ISABELLE

1. ATTACH MOUNTING PLATE TO JUNCTION BOX OR CEILING
2. WIRE TRANSFORMER TO BUILDING
(US: BLACK TO POSITIVE AND WHITE TO NEUTRAL)
3. CUT CORD TO DESIRED LENGTH AND PASS THROUGH CANOPY. WIRE TRANSFORMER TO LAMP
(US: BLACK TO BRAIDED AND RED TO RED)

- NOTE: PURPLE AND GREY CORDS ARE USED ONLY WITH 0-10 V DIMMER SWITCH.**
4. TIGHTEN SET SCREWS ON CORD RELIEF
 5. BRING CANOPY UP TO MOUNTING PLATE WITH BOLTS PASSING THROUGH THE HOLES
 6. SCREW BOTH CAPS DOWN, SECURING THE CANOPY

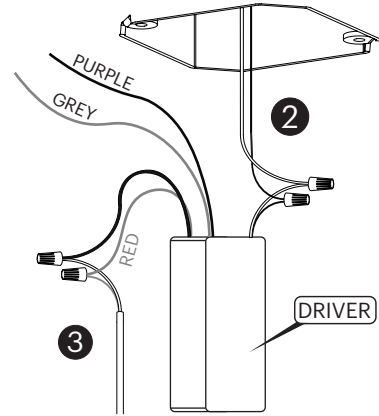
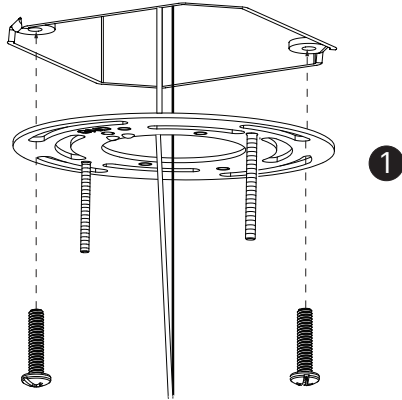

ISABELLE IS A CLASS II FIXTURE. IT DOES NOT REQUIRE GROUNDING.

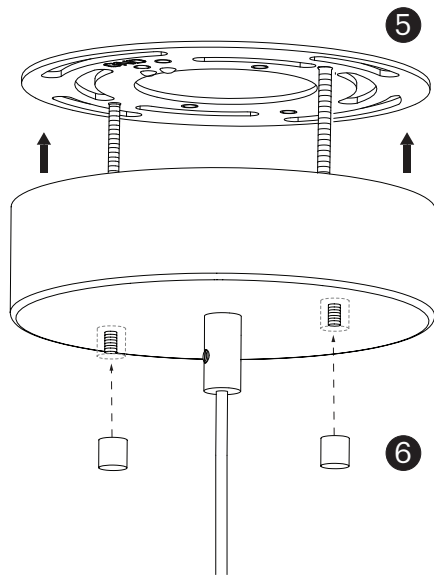
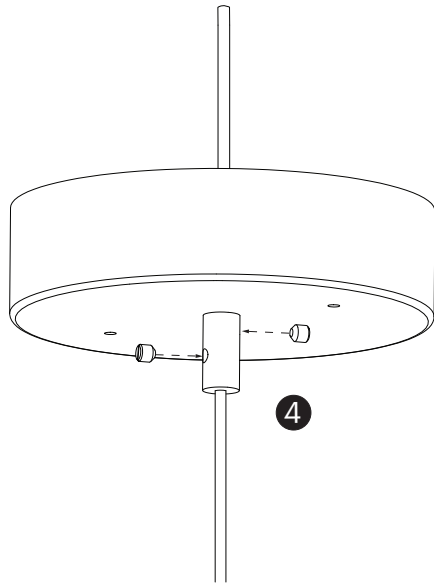

LENGTH OF CORD SUPPLIED
8.9FT (2.7M)

IMPORTANT: WE RECOMMEND CEILING MOUNTING
BE INSTALLED BY AN ELECTRICIAN

ISABELLE

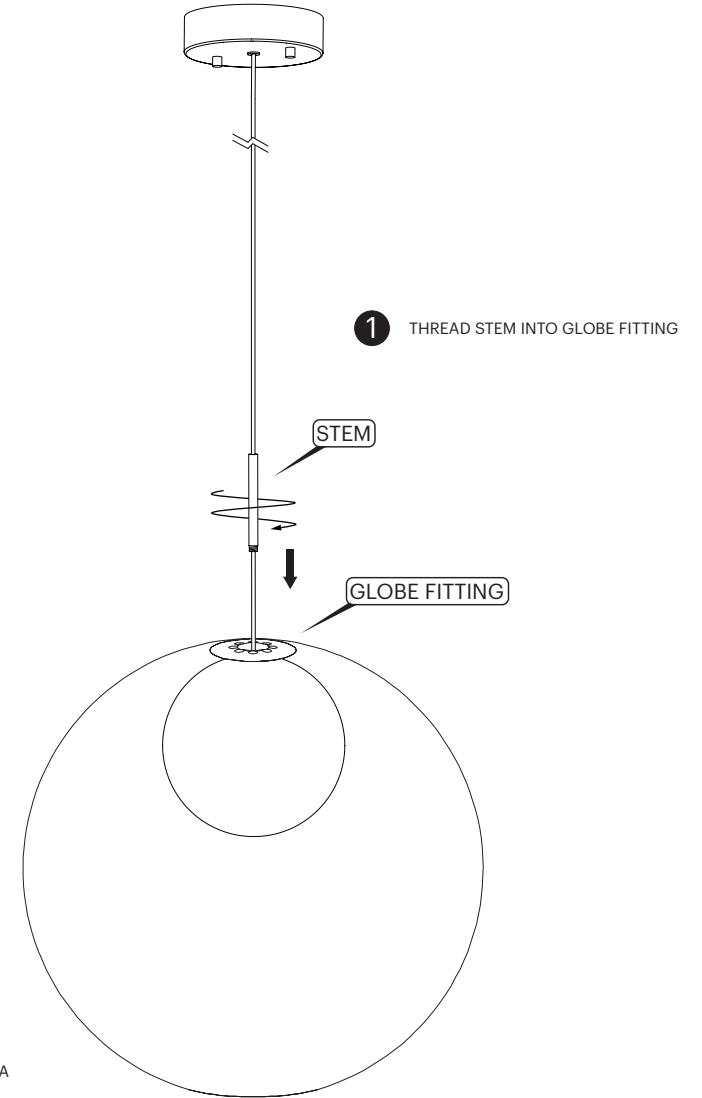

BULB TYPE
LED
FULL RANGE LIGHT CONTROL VIA
120V DIMMER (US)

BULB REPLACEMENT
CONTACT MANUFACTURER FOR BULB
REPLACEMENT

LENGTH OF CORD SUPPLIED
8.9FT (2.7M)

CARE:
WIPE WITH A DRY CLEAN CLOTH.
AVOID AMMONIA BASED CLEANERS.