

POLAR PENDANT

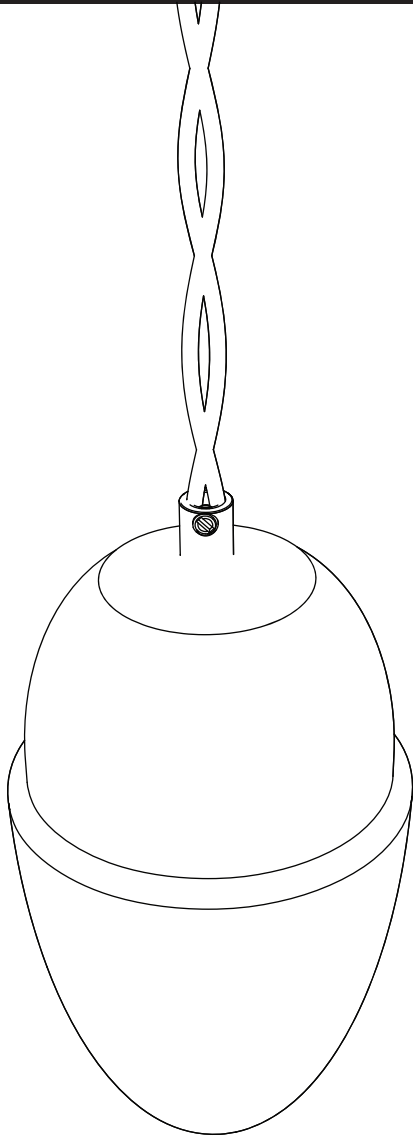

Parts List

A - Canopy Assembly Kit

B - Polar Pendant

C - Bulb

Bulb already inside lighting fixture

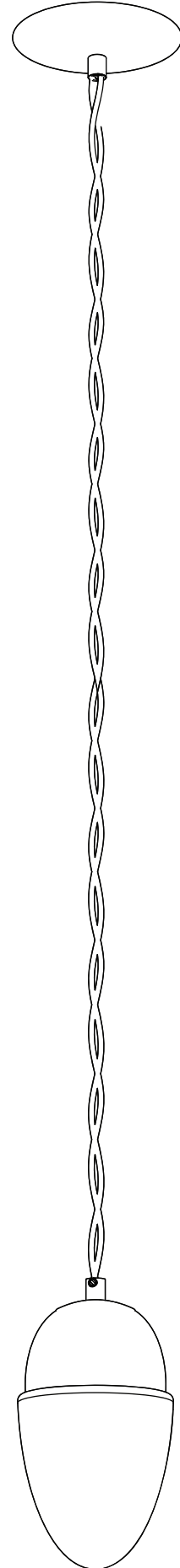

Pendant Install

Turn Off Power

- 1 Thread braided cable and strain relief through the 5" canopy and canopy parts in the order shown. Tie safety knot as shown. Twist matching wires from J-Box and pendant together with Wire Nuts to complete the connection. Tighten strain relief against cord using set screw. Push up Canopy Pan and Thread on Bushing.

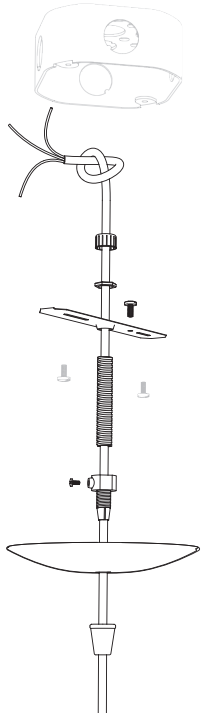

- 2 Return power to J-Box and enjoy your Room & Board pendant.

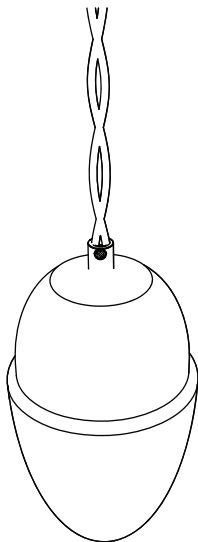

Bulb Replacment

Turn Off Power

- 1 Loosen strain reliefe and lift metal cap off the top of Polar glass.

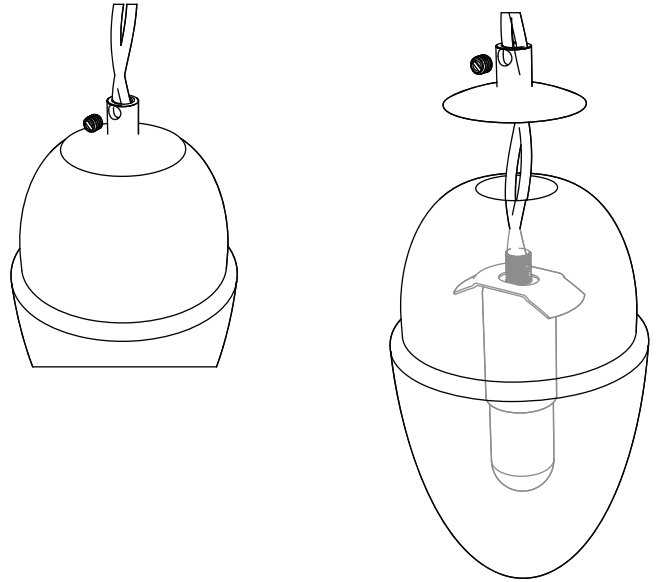

- 2 Turn metal hanger vertical until it fits through the opening in the glass. Slide glass off the fixture assembly and store someplace safe.

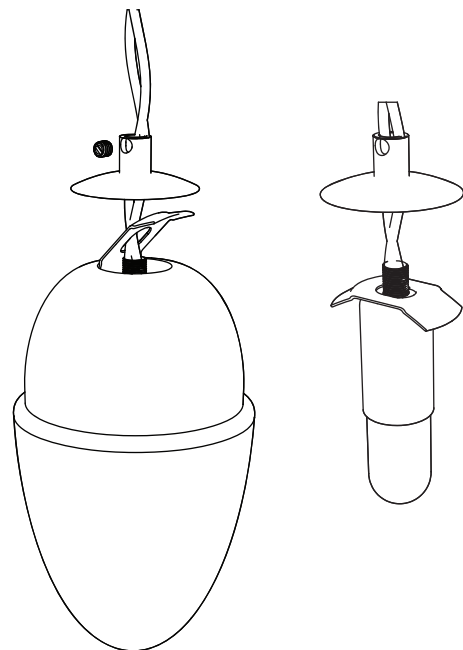

- 3 Unscrew glass diffuser and remove G9 bulb from ceramic socket by gently pulling on plastic shell.

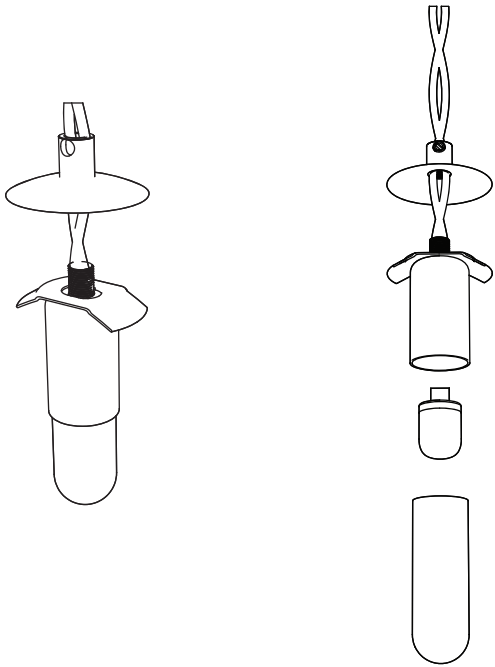

- 4 Work through steps 3 -1 in reverse to reassemble Polar Pendant. Return power to J-Box and enjoy your Room & Board pendant.

