

ASSEMBLY INSTRUCTIONS: HINGE ADJUSTMENT

Linear collection and others

1. Side adjustment: Turn front screw to increase or decrease door overlay ($\pm 2\text{mm}$).

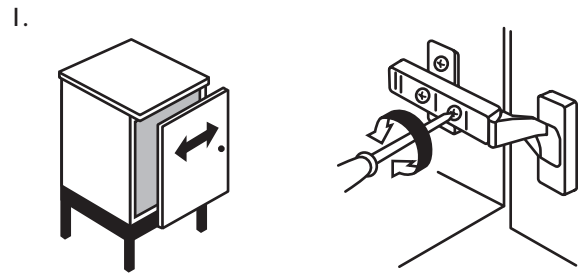

2. Height adjustment: Rotate cam screw on mounting plate to adjust door position ($\pm 2\text{mm}$).

On non-cam mounting plates, loosen screw, adjust door and retighten screws.

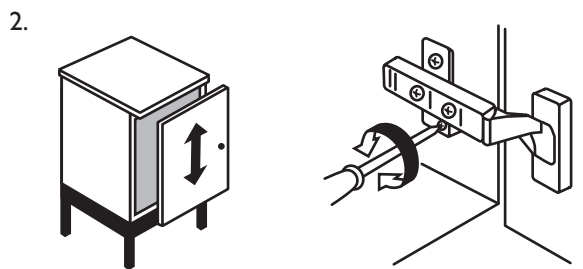

3. Depth adjustment: Turn rear spiral-tech cam screw to adjust door position (+3mm, -2mm).

On clip-style hardware, loosen rear screw, adjust and retighten.

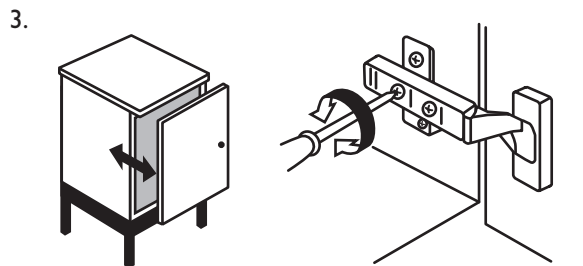

ASSEMBLY INSTRUCTIONS: HINGE ADJUSTMENT

Hudson collection

1. Side adjustment: Turn front screw to increase or decrease door overlay ($\pm 2\text{mm}$).

1.

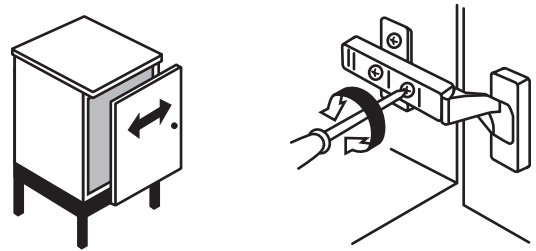

2. Height adjustment: Rotate cam screw on mounting plate to adjust door position ($\pm 2\text{mm}$).

2.

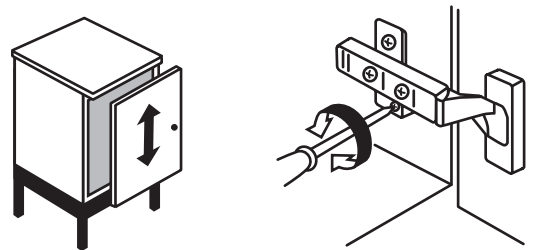

3. Depth adjustment: On clip-style hardware, loosen rear screw, adjust and retighten.

3.

