

ASSEMBLY INSTRUCTIONS

SCOPE OUTDOOR WALL SCNCE

Room&Board

4600 Olson Memorial Highway
Minneapolis, Minnesota 55422
www.roomandboard.com
800.301.9720

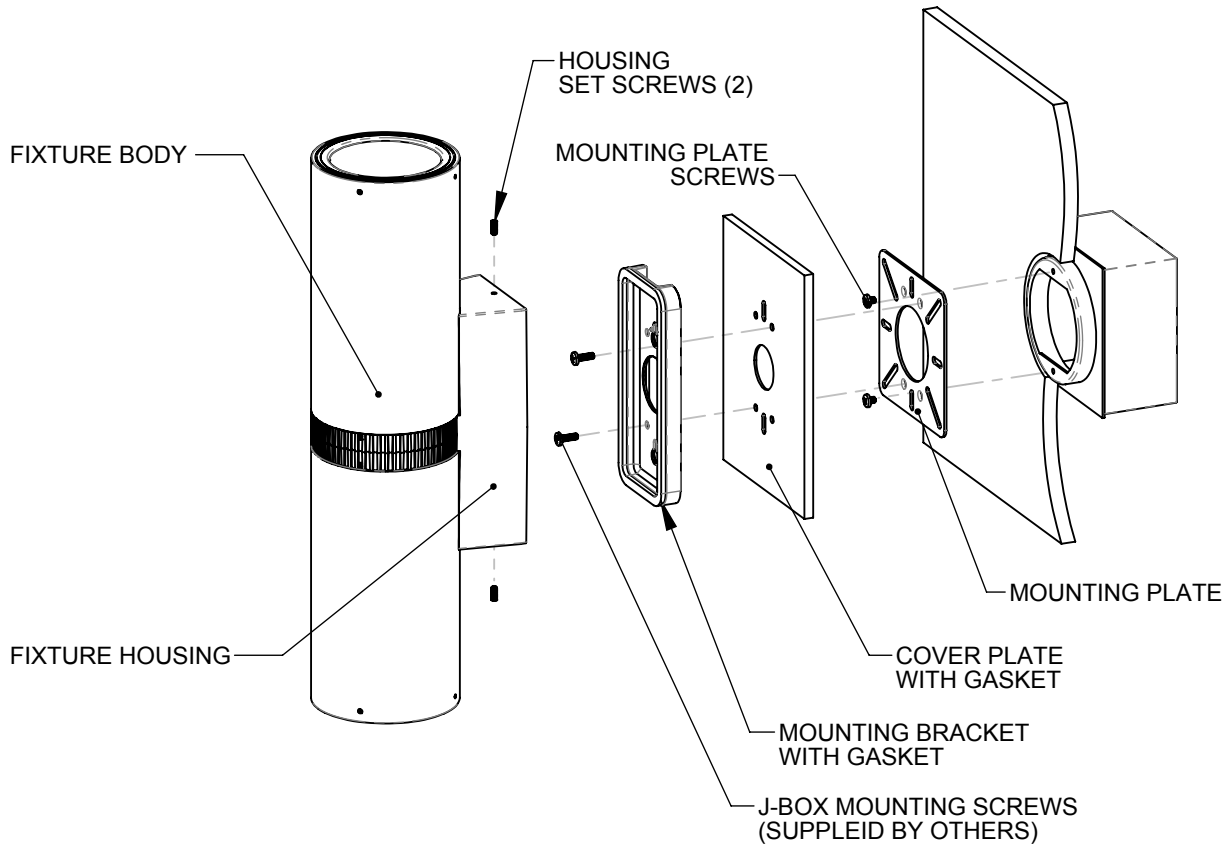

1. Loosen housing set screws in order to separate body and housing from fixture components .
2. Disassemble mounting bracket, cover plate and mounting plate and set aside.
3. Remove mounting plate screws and set aside.
4. Attach mounting plate to junction box with screws (supplied by others).
5. Align cover plate with gasketed-side facing wall and secure cover plate using the screws removed in step 5.
6. Verify cover plate is level and positioned flat against mounting surface. Adjust as needed.
7. Align mounting bracket with gasketed-side facing cover plate and secure with junction box screws (supplied by others).
8. Make supply wire connections using wire nuts. If applicable connect green ground wire to junction box.
9. Position fixture housing over mounting plate and then attach with housing screws provided.

NOTE: To ensure a water-tight seal, apply a continuous bead of sealant around cover plate and housing



When using electrical equipment, basic safety precautions should always be followed, including the following:

- Read all instructions carefully before installing and save for future use.
- Make sure all connections are in accordance with the National Electrical Code and local regulations.
- To avoid possible electric shock, be sure the power supply is turned off before servicing or installing the fixture
- Service should be performed by qualified personnel.
- Please contact Room&Board If additional information is needed.

Drawing: 762312XX

Rev: A

Sheet: 1 of 1

Eng: DEF

Date Drawn: 02/04/2019

Room&Board

4600 Olson Memorial Highway | Minneapolis, Minnesota 55422 | www.roomandboard.com | 800.486.6554